



LOST CLOUD
family restaurant

LOST CLOUD Restaurant located in the ancient port city Famagusta, north Cyprus, near the sea and what is more the site is the bordering with the ghost city Varosha. It is a destination area of the city. Parents bring their children to the playground, because it is safe and calm place. I thought that it would be a wonderful idea to design here a cozy, calm atmosphere for the family restaurant.

The building was built in the 50-60's, the style is modernism. The building had a lot of opening elements and cantilever parts. It gives me an idea of something lightweight and bright. I came to the concept of **CLOUD**.

The cuisine is international. Starting at 7am from Monday to Sunday till 11pm. At weekend there are some nice courses for parents and their children. Parents can participate some different seminars and in the same time their children can cook paste, cakes or play with their cousins. In the interior used bright palette and a lot of natural light to create a very welcoming atmosphere.



Site analysis Building analysis Design research



Concept sheet Bubble diagram Zoning diagram



Family restaurant Graphic design Menu design

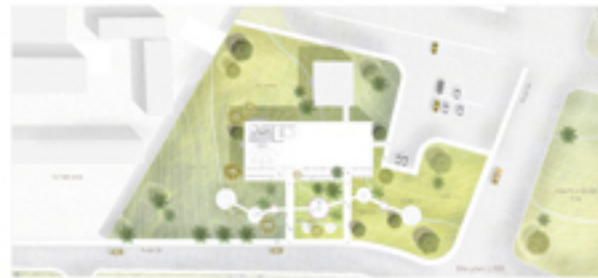

Site plan



Ground floor plan



Top floor plan



Kitchen area details



Dining area details



Lobby area details



Mood board Material board Concept idea



Elevation/sections



Sections



Bakery area



Activity area



Terrace area



Bakery area



Dining area



Top floor area



Kitchen area



Activity area



Entrance area